



# SaniSpray HP 20™

## ELECTROSTATIC SERIES HANDHELD

### WARNING

Read the sprayer manual 3A8070 for complete instructions and warnings. This Quick Guide is not a substitute for reading and understanding all instructions and warning labels supplied with the equipment.

**CHEMICAL HAZARD:** Follow chemical warnings on disinfectant container label and as listed in manual. Do not spray humans or animals. Wear protective equipment.

**FIRE AND EXPLOSION HAZARD:** Do not use any alcohol-based or other flammable liquid in sprayer. Follow fire and explosion warnings as listed in your manual.

**SKIN INJECTION HAZARD:** High pressure equipment. Keep clear of spray tip and leaks. Follow the Pressure Relief Procedure whenever you stop spraying.

**FAILURE TO FOLLOW ALL WARNINGS CAN RESULT IN SERIOUS INJURY, AMPUTATION, OR DEATH.**

### NOTICE

**Do not run sprayer without fluid.**  
Running the sprayer dry will cause damage to the pump.

**Disinfectant left in the sprayer will damage the sprayer. To avoid damage, always completely flush with warm water after every use.**  
**Do not store sprayer with disinfectant in it.**

**Foam in disinfectant may cause operation issues that could damage the sprayer. Wait until foam has subsided to fill Flexliner.**

## KNOW YOUR SPRAYER

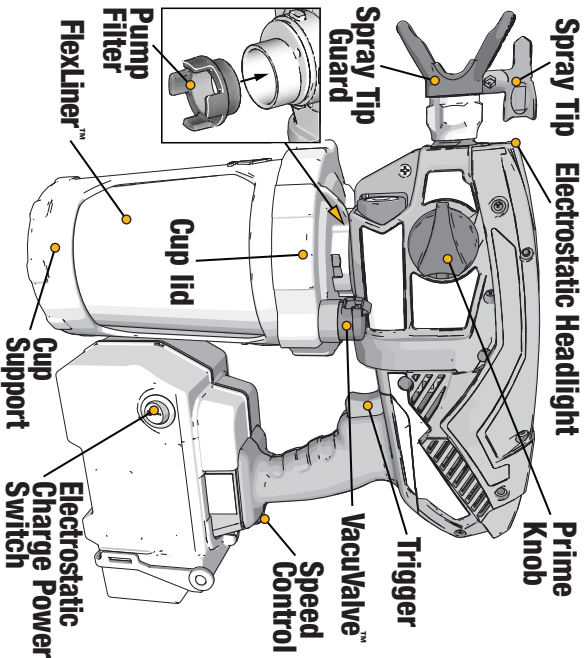

## Pressure Relief Procedure

Follow this procedure whenever instructed to perform **PRESSURE RELIEF PROCEDURE**.

- 1 Disconnect power (unplug cord or remove battery).
- 2 Turn Prime Knob down to PRIME position to relieve pressure.

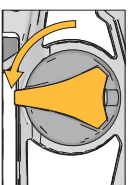

## START UP

Review Important User Information in your sprayer manual to understand which types of disinfectants are compatible with your sprayer.

This sprayer arrives from the factory with a small amount of test fluid in the system. It is important that you flush the sprayer with warm water before using for the first time. See Flushing a New Sprayer in your sprayer manual.

Refer to disinfectant label for manufacturer's directions on proper use. If dilution is required, properly dilute disinfectant in a separate container.

- 1 To begin a new job, first perform the **PRESSURE RELIEF PROCEDURE**.

- 2 Insert one Flexliner into the Cup Support and fill with properly diluted disinfectant.

• **NOTE:** Verify there is no damage, such as a crease, on the top surface of the Flexliner. If damaged DO NOT USE.

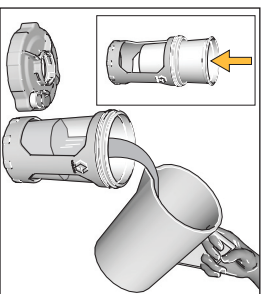

- 3 Firmly tighten Cup Lid onto Cup Support to ensure an air tight seal.

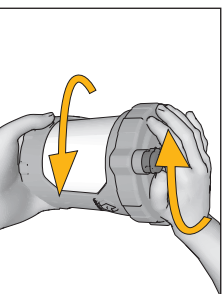

- 4 Install the cup onto the sprayer:
  - A. Verify Pump Filter is installed and clean.
  - B. Align Vacuum Valve (on Cup Lid) with Prime Knob (on sprayer).
  - C. Push cup assembly onto the sprayer. Twist to lock.

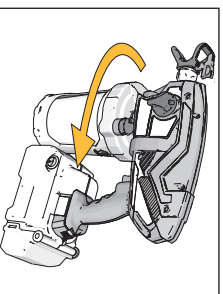
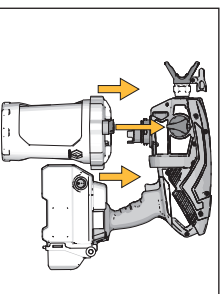

## START UP

continued

- 5 Prime the pump with disinfectant as follows:

- A. Verify Electrostatic Charge Power Switch is in the OFF position.
- B. Verify Prime Knob is pointed down to PRIME position.

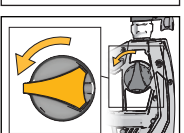
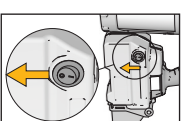

- C. Plug the sprayer into a grounded power source or install a fully charged battery onto the sprayer.

- D. Turn the sprayer upside down.

- Pull the Trigger for 5 seconds.

- **NOTE:** Disinfectant will not spray out, but will recirculate through the pump and back into the cup.

- E. Turn the sprayer upright and open the Vacuum Valve cap.

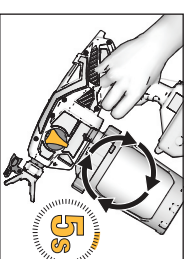

- F. Tilt the sprayer so the Vacuum Valve is the highest point.

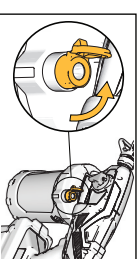

- G. Gently squeeze the Flexliner until disinfectant enters the Vacuum Valve reservoir and all air is evacuated from the cup.

- G. While continuing to squeeze the Flexliner, close the Vacuum Valve cap.

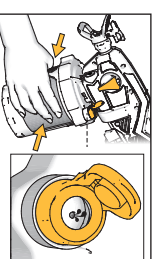

- **NOTE:** If Flexliner is not squeezed while Vacuum Valve Cap is open, air will quickly pull into the Flexliner. If any air bubbles are visible in the cup, repeat steps E-G.

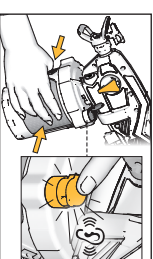

- 6 Verify Spray Tip is forward in the SPRAY position.

- 7 Turn Prime Knob forward to SPRAY position.

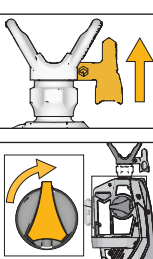

- 8 Pull the Trigger to verify disinfectant sprays from the sprayer. If sprayer does not spray within 5 seconds, STOP and repeat START UP.

- 9 Turn Electrostatic Charge Power Switch to ON position before starting to spray.

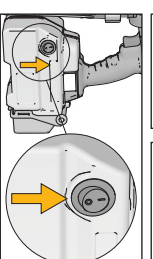

**YOU ARE NOW READY TO SPRAY!**

## HOW TO SPRAY



Review How To Spray in your sprayer manual.

- 1 Adjust the Spray Tip Guard for desired horizontal or vertical spraying direction.
- 2 Point sprayer toward the surface to be sprayed.
- 3 Set the Speed Control to the lowest setting.
- 4 Pull and hold the Trigger and slowly increase the Speed Control to the minimum setting necessary to produce an acceptable spray of disinfectant.
- 5 Adjust the sprayer's distance from the surface and your hand speed to achieve the desired surface coverage.

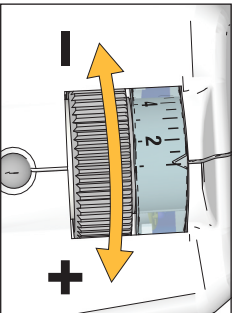
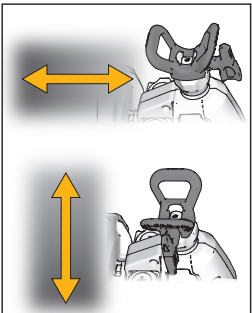

## CUP REFILLS

- 1 To refill cup, first turn Electrostatic Charge Power Switch to the OFF position. Perform the PRESSURE RELIEF PROCEDURE.
- 2 Remove cup assembly from the sprayer. Set sprayer on a rag.
- 3 Remove Cup Lid from Cup Support and refill with properly diluted disinfectant.
- 4 Follow START UP instructions to proceed.

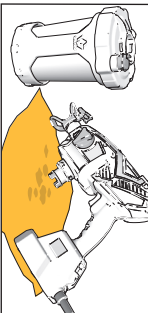
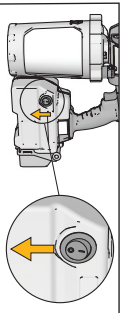

## CLEANUP AND STORAGE

**NOTE:** Disinfectant left in the sprayer will damage the sprayer. To avoid damage, always completely flush with warm water after every use.

See Cleanup and Storage in your sprayer manual.

Do not store sprayer with disinfectant in it.

- 1 To clean up your sprayer, first turn Electrostatic Charge Power Switch to the OFF position. Perform the PRESSURE RELIEF PROCEDURE.
- 2 Remove cup assembly from the sprayer. Set sprayer on a rag.

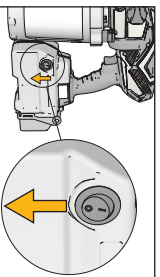

## CLEANUP AND STORAGE

continued

- 3 Remove Cup Lid from Cup Support and pour excess disinfectant into waste bucket.
- 4 You can either dispose of the used Flexliner and install a new Flexliner, or clean a used Flexliner.
- 5 Fill Flexliner with warm water.
- 6 Firmly tighten Cup Lid onto Cup Support to ensure an air tight seal.
- 7 Install the cup onto the sprayer.
- 8 Verify Prime Knob is downward in PRIME position and set Speed Control to #10 setting.
- 9 Turn the sprayer upside down.
- 10 A. Point the sprayer into a waste bucket.  
B. Pull the Trigger for 10 seconds to clean pump.  
• **NOTE:** Water will not spray out, but will recirculate through the pump and back to the cup.
- 11 A. With sprayer upside down point into a waste bucket.  
B. Pull the Trigger for 10 seconds, spraying into the waste bucket.  
C. Reverse the Spray Tip to the UNCLOG position and with sprayer upside down, spray into the waste bucket for 30 seconds.  
• **NOTE:** Do not run sprayer without fluid. Running the sprayer dry will cause damage to the pump.
- 12 Turn Prime Knob to PRIME position and disconnect power (remove battery).
- 13 B. Dispose of all waste fluid according to the instructions on the disinfectant container label and applicable regulations.
- 14 Remove and clean the Spray Tip, Spray Tip Guard, Pump Filter, Cup Support and Cup Lid with warm water. Clean the outside of the sprayer with a soft cloth moistened with warm water.

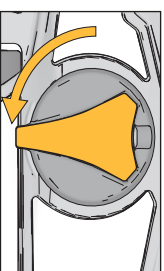
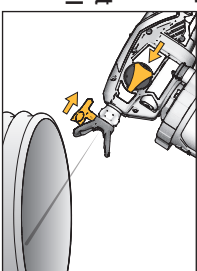
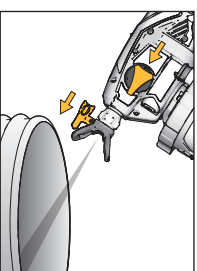
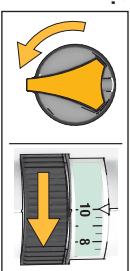
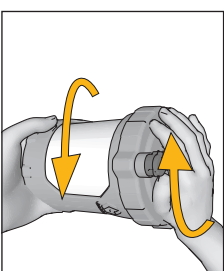
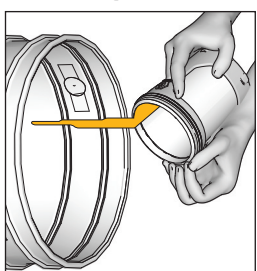

## TROUBLESHOOTING

If the sprayer does not spray, try the steps below:

- Make certain the sprayer has a fully charged battery installed.
- Make certain the Spray Tip is not plugged. See Clean Tip Clogs in your sprayer manual for instructions on how to reverse and easily clear a clog.
- Verify Cup Lid is tight. An under tightened Cup Lid will allow air to seep into the Flexliner and cause a loss of prime.
- Make certain the Cup Lid is properly threaded to the Cup Support. If threads are visible below the Cup Lid when tight, then the Cup Lid is cross-threaded.
- Make certain there is no damage, such as a crease, on the top surface of the Flexliner. If damaged, DO NOT USE.
- Make certain there is only one Flexliner in the Cup Support. Multiple Flexliners nested tightly together can go unnoticed.
- Repeat START UP step 5 to ensure all air is evacuated from the Flexliner.
- If necessary, replace VacuValve cap. Two new VacuValve caps came with your sprayer.

If you feel static shocks while spraying you are likely not adequately grounded to either the sprayer or to the floor. Try the following:

- Your sprayer has an in-handle grounding plate that will ground your hand to the sprayer while spraying.
- If you cannot contact the in-handle grounding plate, such as when wearing gloves, plug the wrist grounding strap into the ground port on the battery shield and place the wrist strap on bare skin of wrist or arm. Tighten to get a good ground connection.
- Thick soled shoes can inhibit grounding. Change to different shoes or add the included heel grounding strap to the outside of one shoe. Instructions for use are included with the heel grounding strap.
- See Troubleshooting in your sprayer manual for more information.



**GRACO**